



X9 CLIP ON TUNER

RECHARGEABLE

Multi-Mode Functionality

FEATURES

- Chromatic tuner with Guitar, Bass, Ukulele and Violin modes.
- Built-in rechargeable battery allows over 15 hours continuous use per charge.
- VA-LCD screen, High contrast screen, clearer display and easy to read.
- Swivel clip to suit different angles
- Auto power off function for maximum battery life.
- Reference pitch range 430-450 Hz

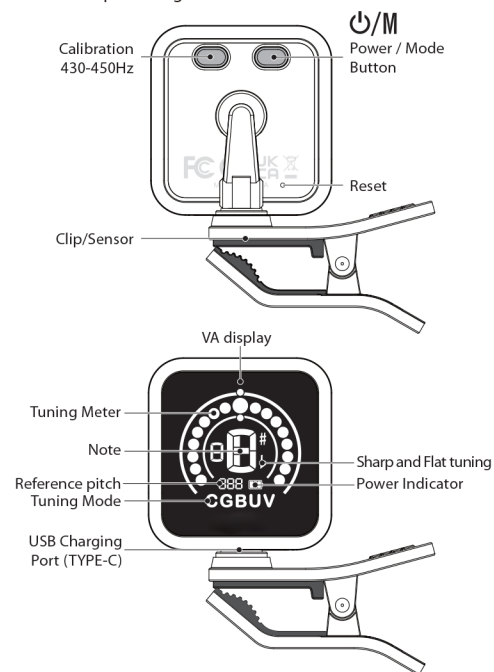

OPERATION

1. Power/Mode button

Short press for turn On, Press for 2 seconds to turn Off
When the device is on, short press this button to switch between the four different tuning modes.
C (Chromatic), G (Guitar), B (Bass), U (Ukulele C), V (Violin).

2. Attach the tuner to your instruments headstock using the clip. Different position sensitivity will vary

3. Play a Single Note:

The display will show the note name and string number closest to the detected pitch. Tune the string until the VA display shows the correct string and note. The indication arrows and circle in the middle will show if the string is in tune.

4. Tuning Visuals



- Yellow dot leads a low note from bottom to center.
- Red dot leads a high note from top to center
- A perfectly tuned note is indicated by two green side dot and a green circle in the center.

5. Auto Note Detection:

Chromatic: C C# D D# E F F# G G# A A# B

Guitar: 6E 5A 4D 3G 2B 1E

Bass: 5B 4E 3A 2D 1G

Ukulele C: 4G 3C 2E 1A

Violin: 4G, 3D, 2A, 1E

6. 430-450 button

Press and hold the button to adjust the default standard reference pitch (440Hz) anywhere from 430Hz to 450Hz.

BATTERY CHARGING

When the battery level is running low, please use the included USB charging cable to recharge the unit.



NOTE:

This device uses Li-Po battery, to reach the maximum battery life, please charge it before using it. If the device will not be used for a long time, please charge it at least once every 3 months to maintain battery health.

Input: DC 5.0V, <=100mA

Output: 3.7V/200mAh Polymer Li-ion battery, <=15mA

SPECIFICATIONS

Tuning modes: Chromatic, Guitar, Bass, Ukulele C, Violin

Tuning range: B0 ~ B7

Precision: ± 1 cent

Calibration: 430-450Hz

Power supply: 3.7V/180mAh Polymer Li-ion battery,

Dimensions:

W : 42 mm (1,65") x H : 44mm (1,73") x D : 14mm (0,55")

IMPORTANT SAFETY INSTRUCTIONS PLEASE READ THESE INSTRUCTIONS AND KEEP IN A SAFE PLACE



WARNING:

BEFORE USING YOUR PRODUCTS,
CAREFULLY READ THE OPERATING INSTRUCTIONS.

1. Observe all instructions carefully in the manual.
2. Do not to perform service operations beyond those described in the manual. Service is required when the apparatus has been damaged in any way, such as:
 - Liquid has been spilled or objects have fallen into the apparatus
 - The unit has been exposed to rain or moisture
 - The unit does not operate normally or changes in performance in a significant way
 - The unit is dropped or the enclosure is damaged

3. Do not place near heat sources, such as radiators, heat registers, or appliances which produce heat.
4. Guard against objects or liquids entering the device. Do not use or place unit near water.
5. Clean only with a dry cloth.
6. Only use attachments/accessories specified by the manufacturer.

SAFETY INSTRUCTIONS FOR LITHIUM-ION RECHARGEABLE BATTERIES

If abused or misused, the rechargeable batteries may leak. In extreme cases, they may even present a risk of explosion, fire, heat, smoke or gas. EHX does not accept any liability for damage arising from abuse or misuse.

- Keep away from children.
- Only charge rechargeable batteries with chargers recommended by EHX.
- Observe correct polarity.
- Pack/store charged rechargeable batteries so that the terminals cannot contact each other (danger of shorting out/fire hazard).
- Do not expose to moisture.
- Switch rechargeable battery-powered products off after use.
- Only charge rechargeable batteries at ambient temperatures between 10°C/50°F and 40°C/104°F.
- When not using rechargeable batteries for extended periods of time, charge them regularly (about every three months).
- Do not mutilate or dismantle.
- Do not heat above 60°C/140°F, e.g. do not expose to sunlight or throw into a fire.
- Immediately remove rechargeable batteries from obviously defective products.
- Do not continue to use defective rechargeable batteries.
- Only use rechargeable batteries specified by EHX.
- Dispose of rechargeable batteries at special collection points or return them to your specialist dealer.
- Store the products in a cool and dry place at room temperature (approx. 20°C/68°F).
- Remove the rechargeable batteries if the products will not be used for extended periods of time.

INFORMATION ABOUT COLLECTION AND DISPOSAL OF OLD ITEMS AND USED BATTERIES

To protect our environment, please take old products and used batteries to proper collection places; and, in the EU, follow your national legislation and the Directives 2012/19/EU and 2006/66/EC.

When disposing of old products and batteries, please help to save valuable resources and prevent any possibilities of side effects on human health and the environment.

You can contact your local authority to find out how to dispose of old products and used batteries responsibly.

For product owners in the European Union:

If you want to discard electrical and electronic items, please contact your dealer or supplier for further information.

Information on Disposal in other Countries outside the European Union:

Please contact your local authorities or dealer for more information regarding the disposal of old items and used batteries.

The symbols shown below are valid only in the European Union. They indicate that you must not mix used electronic products and batteries with general household garbage.

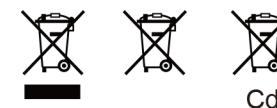

Cd

THE FCC REGULATION WARNING (for U.S.A.)

This equipment has been tested and found to comply with the limits for a Class B digital device, pursuant to Part 15 of the FCC Rules. These limits are designed to provide reasonable protection against harmful interference in a residential installation. This equipment generates, uses, and can radiate radio frequency energy and, if not installed and used in accordance with the instructions, may cause harmful interference to radio communications. However, there is no guarantee that interference will not occur in a particular installation. If this equipment does cause harmful interference to radio or television reception, which can be determined by turning the equipment off and on, the user is encouraged to try to correct the interference by one or more of the following measure:

- Reorient or relocate the receiving antenna.
- Increase the separation between the equipment and receiver.
- Connect the equipment into an outlet on a circuit different from that to which the receiver is connected.
- Consult the dealer or an experienced radio/TV technician for help

ELECTRO-HARMONIX

47-50 33rd Street
Queens, NY 11101
www.ehx.com



Made In China